

PLANO DE AERÓDROMO-OACI

38°56'55"N  
001°51'48"W

ELEV 701

TWR 122.100  
GND 121.800

ALBACETE

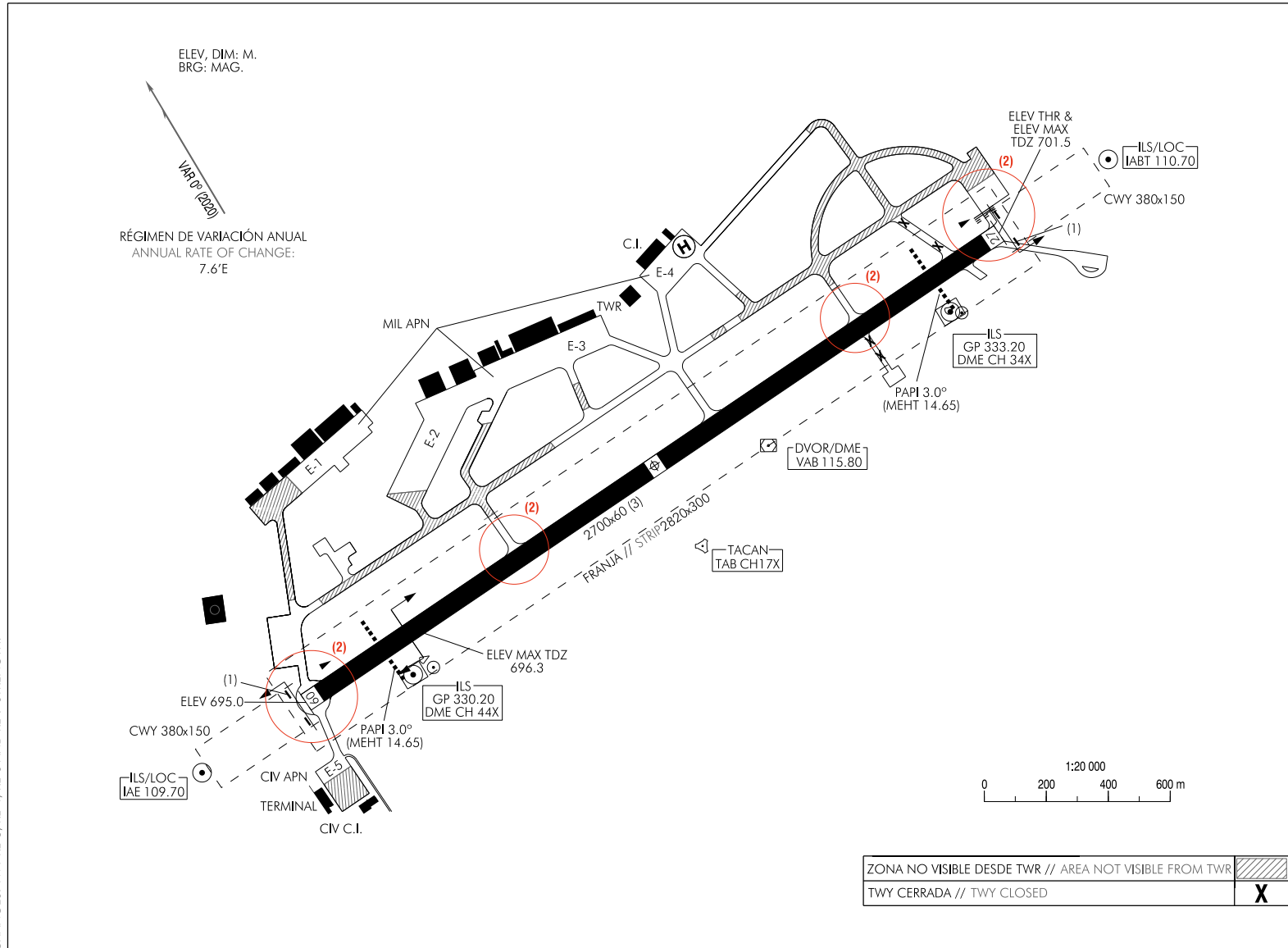

RWY	DIRECCIÓN DIRECTION	THR
09	088°	38°56'52.68"N 001°52'44.83"W
27	268°	38°56'56.14"N 001°50'52.75"W

RESISTENCIA // STRENGTH	
RWY: PCN 94/F/A/W/T	
CIV APN: E-5: PCN 32/F/A/W/T	
MIL APN: E-1: PCN 43/R/A/W/T E-2: PCN 43/R/B/W/T E-3: PCN 88/R/A/W/T E-3.1: PCN 85/R/A/W/T E-4: PCN 82/R/A/W/T	
TWY: A & RE-5: PCN 23/F/B/W/T B: PCN 46/F/A/W/T C: PCN 26/F/A/W/T D, R-2, R-3: PCN 43/F/B/W/T R-1: PCN 43/F/B/W/T; PCN 51/F/A/W/T R-4: PCN 43/F/B/W/T; PCN 55/F/B/W/T E: PCN 50/F/B/W/T F: PCN 32/F/A/W/T RE-1: PCN 68/R/B/W/T RE-2: PCN 102/F/A/W/T RE-3: PCN 5/F/D/W/T RE-4: PCN 10/F/C/W/T RE-6: PCN 9/F/A/W/T RE-7: PCN 11/F/A/W/T RF1: PCN 41/F/B/W/T	

NOTAS // NOTES					
(1) BARRERA DE RED Y CABLE // NET AND CABLE BARRIER.					
(2) LUGARES CRÍTICOS: VER AD 2-LEAB GMC. HOT SPOTS: SEE AD 2-LEAB GMC.					
(3) ASPH CONC.					
SWY (MIL) (3) 380x60	FRANJA // STRIP (MIL) 3078x60				
<table border="1" style="width: 100%;"> <tr> <td>ZONA NO VISIBLE DESDE TWR // AREA NOT VISIBLE FROM TWR</td> <td style="background-color: #cccccc;"></td> </tr> <tr> <td>TWY CERRADA // TWY CLOSED</td> <td style="text-align: center; font-weight: bold; font-size: 24px;">X</td> </tr> </table>		ZONA NO VISIBLE DESDE TWR // AREA NOT VISIBLE FROM TWR		TWY CERRADA // TWY CLOSED	X
ZONA NO VISIBLE DESDE TWR // AREA NOT VISIBLE FROM TWR					
TWY CERRADA // TWY CLOSED	X				

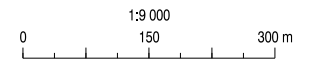
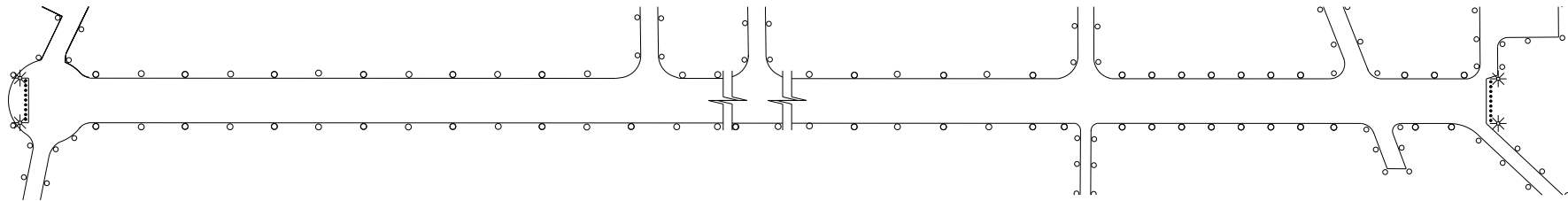
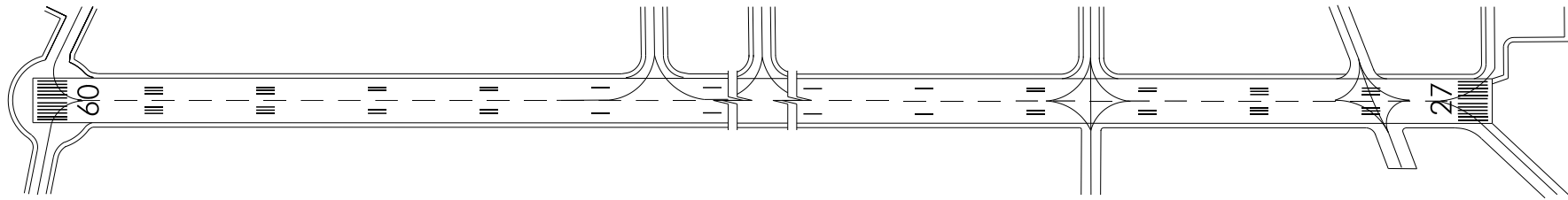

CAMBIOS: REIMPRESIÓN  
CHANGES: REPRINTED.