

PLANO DE AERÓDROMO-OACI

40°29'48"N
003°26'45"W

ELEV 618

TWR 122.100
339.600
GMC 118.300
396.900

MADRID/Torrejón

RWY	DIRECCIÓN DIRECTION	THR	RESISTENCIA STRENGTH
04	044°	40°29'05.18"N 003°27'38.52"W	RWY 04/22: PCN 148/R/C/W/T (2) PCN 82/F/A/W/T (3) PCN 62/F/A/W/T (4) PCN 267/F/A/W/T (5) PCN 158/R/B/W/T (6) TWY: C1: PCN 146/R/B/W/T C2: PCN 89/F/A/W/T C3: PCN 146/F/A/W/T C4: PCN 98/F/A/W/T C5: PCN 62/R/B/W/T C6, C61: PCN 74/R/B/W/T C62, C63: PCN 242/F/A/W/T C7: PCN 99/R/A/W/T C8: PCN 57/R/C/W/T C9: INFO NO AVBL
04D (1)	044°	40°29'26.99"N 003°27'11.51"W	RWY 04D: PCN 62/F/A/W/T (4) PCN 267/F/A/W/T (5) PCN 158/R/B/W/T (6)
22	224°	40°30'31.39"N 003°25'51.77"W	APN: PE 1: PCN 67/R/B/W/T PE 2: PCN 72/R/B/W/T PE 3,4: PCN 77/R/B/W/T PE 5: PCN 80/R/A/W/T PE 6: PCN 79/R/A/W/T PE 7: PCN 56/R/B/W/T PE 8: PCN 136/R/C/W/T PE 9: INFO NO AVBL

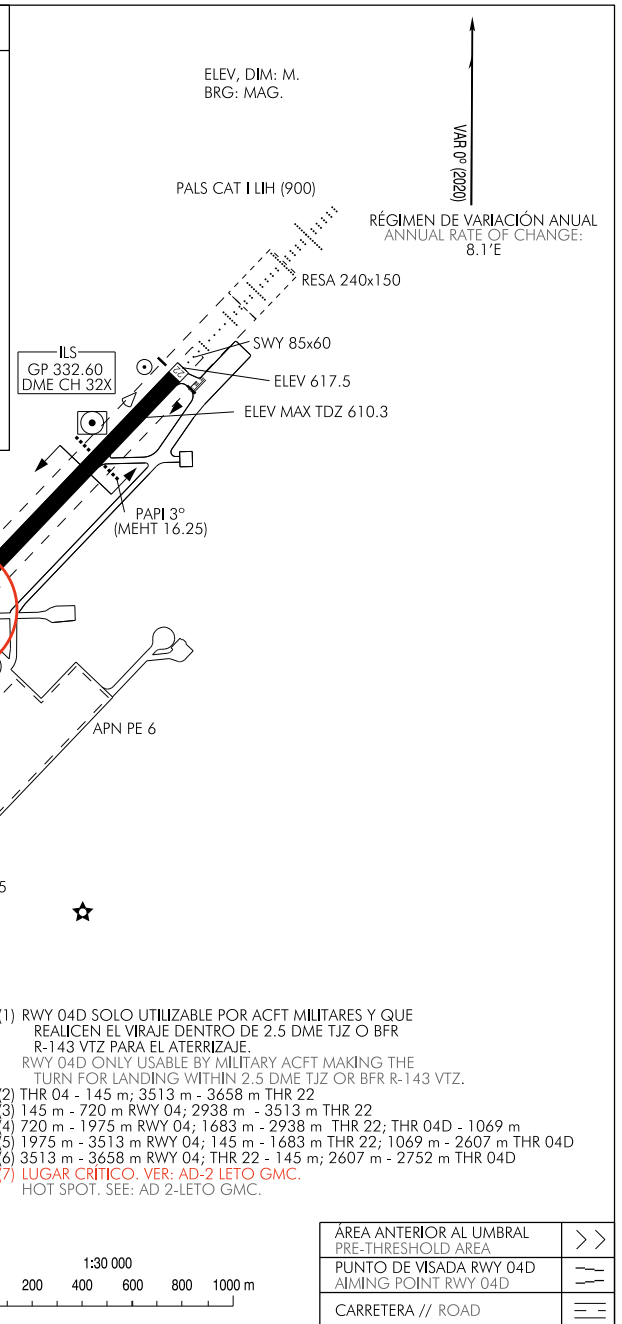

- (1) RWY 04D SOLO UTILIZABLE POR ACFT MILITARES Y QUE REALICEN EL VIRAJE DENTRO DE 2.5 DME TJZ O BFR R-143 VTZ PARA EL ATERRIZAJE.
RWY 04D ONLY USABLE BY MILITARY ACFT MAKING THE TURN FOR LANDING WITHIN 2.5 DME TJZ OR BFR R-143 VTZ.
- (2) THR 04 - 145 m; 3513 m - 3658 m THR 22
- (3) 145 m - 720 m RWY 04; 2938 m - 3513 m THR 22
- (4) 720 m - 1975 m RWY 04; 1683 m - 2938 m THR 22; THR 04D - 1069 m
- (5) 1975 m - 3513 m RWY 04; 145 m - 1683 m THR 22; 1069 m - 2607 m THR 04D
- (6) 3513 m - 3658 m RWY 04; THR 22 - 145 m; 2607 m - 2752 m THR 04D
- (7) LUGAR CRÍTICO. VER: AD-2 LETO GMC.
HOT SPOT. SEE: AD 2-LETO GMC.

CAMBIOS: NUEVAS TWY Y APN. LUGARES CRÍTICOS. DECLINACIÓN MAGNÉTICA. RÉGIMEN DE VARIACIÓN ANUAL. CORRECCIÓN EDITORIAL. CHANGES: NEW TWY AND APN. HOT SPOTS. MAGNETIC VARIATION. ANNUAL RATE OF CHANGE. FORMAL EDITING.

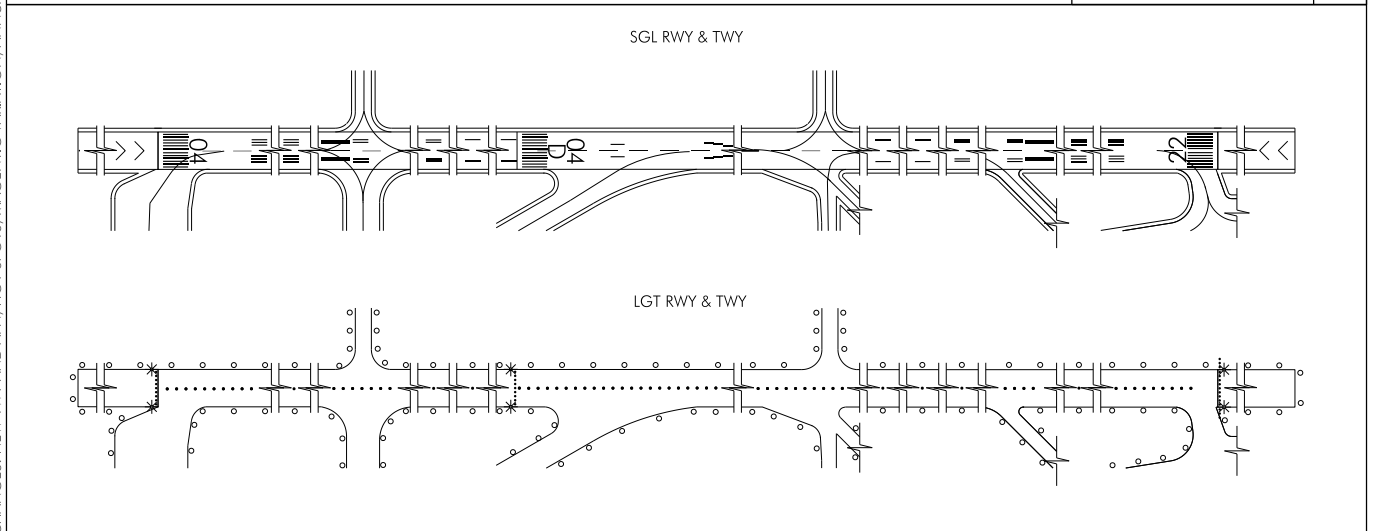

INTENCIONADAMENTE EN BLANCO
INTENTIONALLY BLANK