

PLANO DE ESTACIONAMIENTO
Y ATRAQUE DE AERONAVES-OACI

ELEV APN
507

TWR 118.450
GMC 121.800

VITORIA

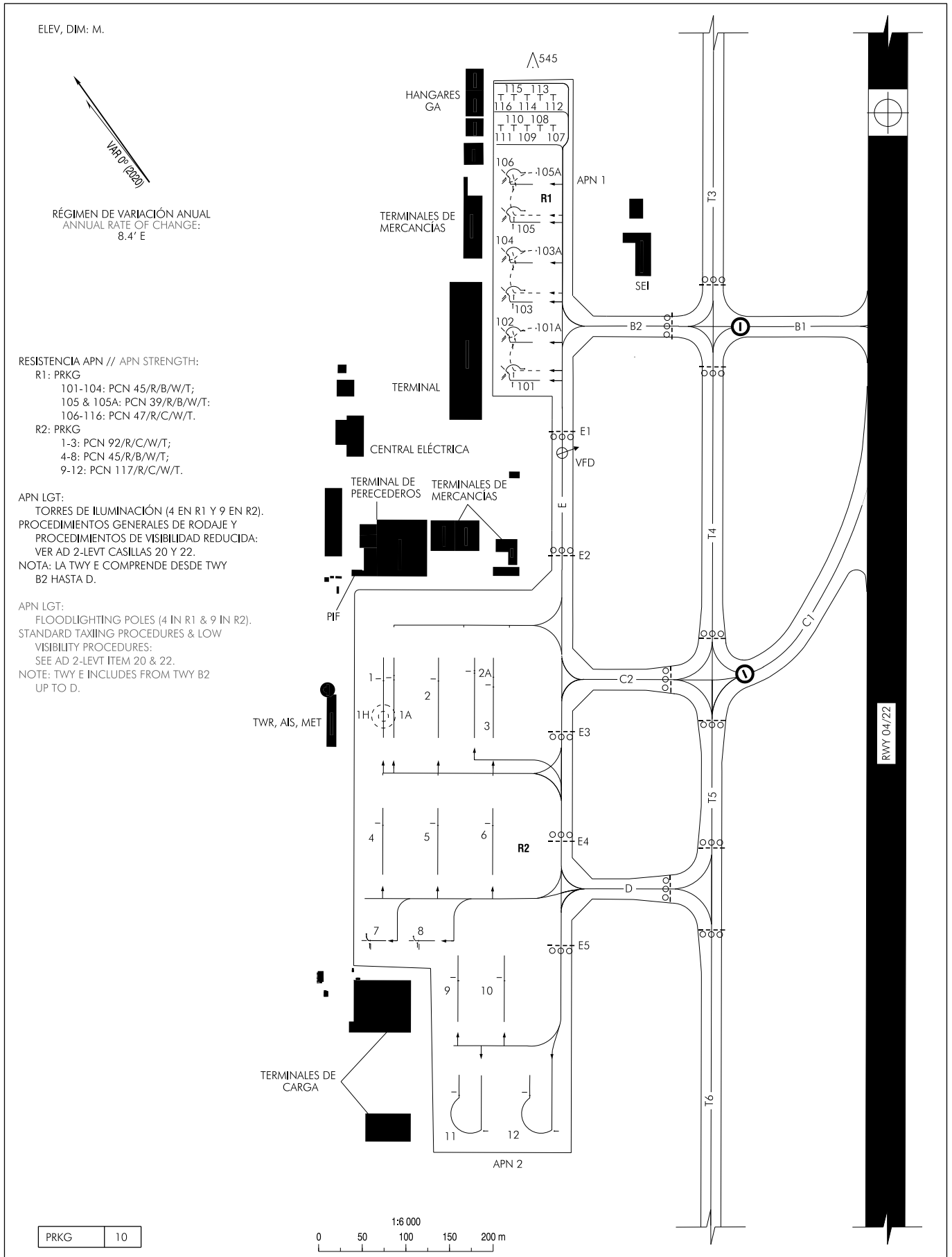

CAMBIOS: RESISTENCIA APN.
CHANGES: APN STRENGTH.

CARACTERÍSTICAS DE LOS PUESTOS DE ESTACIONAMIENTO
AIRCRAFT STANDS CHARACTERISTICS

PUESTO STAND	RAMPA RAMP	COORDENADAS COORDINATES	SALIDA EXIT	MAX ACFT	APROAR NOSE TO	OBSERVACIONES REMARKS
1	R2	42°52'52.06"N 002°44'05.55"W	A	B763	-	INCOMP. 1A & 1H
1A	R2	42°52'51.87"N 002°44'05.08"W	A	B744	-	INCOMP. 1, 1H & 2
1H	R2	42°52'51.00"N 002°44'06.59"W	A	D = 23 m	-	HEL. INCOMP. 1 & 1A
2	R2	42°52'50.87"N 002°44'03.30"W	A	B763	-	INCOMP. 1A & 2A
2A	R2	42°52'50.01"N 002°44'01.79"W	A	B748	-	INCOMP. 2 & 3
3	R2	42°52'49.50"N 002°44'01.22"W	A	B764	-	INCOMP. 2A
4	R2	42°52'47.73"N 002°44'09.84"W	A	B763	-	-
5	R2	42°52'46.53"N 002°44'07.59"W	A	B763	-	-
6	R2	42°52'45.33"N 002°44'05.34"W	A	B763	-	-
7	R2	42°52'44.56"N 002°44'13.83"W	A	SW4	-	-
8	R2	42°52'43.54"N 002°44'11.91"W	A	SW4	-	-
9	R2	42°52'41.41"N 002°44'11.34"W	A	B752 (1)	-	-
10	R2	42°52'40.40"N 002°44'09.44"W	A	B752 (1)	-	-
11	R2	42°52'37.94"N 002°44'14.69"W	A	B752 (1)	-	-
12	R2	42°52'36.39"N 002°44'11.80"W	A	B752 (1)	-	-
101	R1	42°52'58.65"N 002°43'51.35"W	A	DH8B	-	INCOMP 101A
101A	R1	42°52'59.51"N 002°43'50.06"W	A	B753	-	INCOMP 101 & 102
102	R1	42°52'59.80"N 002°43'50.22"W	A	DH8B	-	INCOMP. 101A
103	R1	42°53'01.01"N 002°43'49.02"W	A	DH8B	-	INCOMP. 103A
103A	R1	42°53'01.84"N 002°43'47.76"W	A	B753	-	INCOMP 103 & 104
104	R1	42°53'02.19"N 002°43'47.86"W	A	DH8B	-	INCOMP. 103A
105	R1	42°53'03.41"N 002°43'46.66"W	A	DH8B	-	INCOMP. 105A
105A	R1	42°53'04.18"N 002°43'45.45"W	A	B753	-	INCOMP 105 & 106
106	R1	42°53'04.55"N 002°43'45.53"W	A	DH8B	-	INCOMP. 105A
107	R1	42°53'05.12"N 002°43'42.17"W	A	(2)	-	-
108	R1	42°53'05.41"N 002°43'42.71"W	A	(2)	-	-
109	R1	42°53'05.70"N 002°43'43.24"W	A	(2)	-	-
110	R1	42°53'05.98"N 002°43'43.78"W	A	(2)	-	-
111	R1	42°53'06.27"N 002°43'44.31"W	A	(2)	-	-
112	R1	42°53'06.05"N 002°43'41.27"W	A	(2)	-	-
113	R1	42°53'06.33"N 002°43'41.80"W	A	(2)	-	-
114	R1	42°53'06.62"N 002°43'42.33"W	A	(2)	-	-
115	R1	42°53'06.90"N 002°43'42.87"W	A	(2)	-	-
116	R1	42°53'07.19"N 002°43'43.41"W	A	(2)	-	-

Observaciones // Remarks:

(1)	B757-200 con // with winglets.
(2)	Envergadura máxima // Maximum wingspan: 12 m.