

LESA AD 2 AERODROME DATA

LESA AD 2.1 AERODROME LOCATION INDICATOR AND  NAME

LESA - SALAMANCA/Matacán

LESA AD 2.2 AERODROME GEOGRAPHICAL AND ADMINISTRATIVE DATA

1	ARP	405707N 0053007W. See AD 2-LESA ADC.
2	Distance and direction from the city	15 km E.
3	Elevation	791 m / 2595 ft.
4	Geoid undulation	55.04 m ± 0.05 m (1).
5	Reference temperature	30°C.
6	Low average temperature	3°C.
7	Magnetic variation	0° W (2025).
8	Annual change	9.9' E.
9	AD administration	Ejército del Aire y del Espacio.
10	Address	CIV: Aeropuerto de Salamanca. 37071 - Salamanca. MIL: Base Aérea de Matacán. 37071 - Salamanca.
11	TEL	CIV: +34-923 329 600 MIL: +34-923 129 500
12	FAX	CIV: +34-923 329 629 MIL: +34-923 129 777
13	AFTN	LESA
14	E-mail	CIV: osalamanca@aena.es MIL: ctamatacan@ea.mde.es
15	Approved traffic	VFR/IFR.
16	Remarks	(1) For all AD points.

LESA AD 2.3 OPERATIONAL HOURS

1	Airport	CIV: I: 0730-1630; V: 0800-1900. (1) MIL: I: MON-FRI 0630-1630; SAT, SUN & HOL: 0730-1630. (2)(3)(4) V: MON-FRI 0530-1900; SAT, SUN & HOL: 0800-1900. (2)(3)(4)
2	Customs and Immigration	HR CIV AD O/R with 72 HR in advance.
3	Health and Sanitation	No.
4	AIS/ARO/OPV	HR MIL AD.
5	MET briefing	I: 0600-1800. (5) V: MON-FRI: 0500-1900; SAT & SUN: 0600-1900. (5)

6	ATS	HR MIL AD.
7	Fuelling	CIV: HR CIV AD for Civil Aviation. MIL: HR MIL AD for military flights and Spanish state aircraft. Outside these hours O/R.
8	Handling	CIV: HR CIV AD for Civil Aviation. MIL: HR MIL AD for military flights and Spanish state aircraft. Outside these hours O/R.
9	Security	H24.
10	De-icing	No.
11	Remarks	(1) See item 20: Local regulations. (2) State Security Forces, Military and other Spanish state aircraft, see item 20: Local regulations. (3) Foreign state/military aircraft. See item 20: Local regulations. (4) Other hours according to training periods. (5) Other hours according to NOTAM. Outside of this schedule, a half-hourly METAR AUTO will be issued.

LESA AD 2.4 HANDLING SERVICES AND FACILITIES

1	Cargo facilities	MIL: 4 cranes of 10000 Lb and 3 towing tractors.
2	Fuel types	CIV: JET A-1, AVGAS. MIL: F-34.
3	Oil types	CIV: AEROSHELL W100. MIL: G-354, O-156 and S-743.
4	Refuelling capacity	CIV: AVGAS: <ul style="list-style-type: none"> 1 truck 3000 L, 3.8 L/s. JET A1: <ul style="list-style-type: none"> 1 truck 12000 L, 18.3 L/s. 1 truck 10000 L, 12.5 L/s. MIL: trucks 20000 L; 16.6 L/s.
5	De-icing facilities	No.
6	Hangar space	No.
7	Repair facilities	No.
8	Remarks	MIL: GPU: AC unit (up to 45 KVA) and DC (up to 1500 A). Ramp agents: SOUTH EUROPE GROUND SERVICES <ul style="list-style-type: none"> TEL.: +34-606 713 212; +34-659 675 436 E-mail: slmkq@southeu.com SITA: SLMKQIB

LESA AD 2.5 PASSENGER FACILITIES

1	Hotels	MIL: Yes.
2	Restaurant	MIL: Yes.
3	Transportation	CIV: Taxis and hire cars. MIL: Buses and light vehicles available on request.

4	Medical facilities	MIL: First aid and motor ambulance.
5	Bank/Post Office	MIL: Cash dispenser/No.
6	Tourist information	No.
7	Remarks	None.

LESA AD 2.6 RESCUE AND FIREFIGHTING SERVICES

1	Fire category	CIV: 5. On demand 6 and 7. (1) MIL: 4. H24 (2).
2	Rescue equipment	CIV: In accordance with the fire category published. MIL: Yes.
3	Removal of disabled aircraft	MIL: Yes. Equipment Luna RSL 45/9000-A with hook maximum capacity 30 TN. CIV: 1 small towing truck. 1 tractor.
4	Remarks	(1) See item 20, "Procedure for the request of fire category on demand". (2) MIL category expandable up to 7 PPR 24 HR.

LESA AD 2.7 RUNWAY SURFACE CONDITION ASSESSMENT AND REPORTING AND SNOW PLAN

1	Equipment	MIL: Yes.
2	Priority	No.
3	Remarks	None.

LESA AD 2.8 APRONS, TAXIWAYS AND CHECK LOCATIONS/POSITIONS DATA

1	Apron	Surface: Concrete. Strength: MIL apron: PCN 34/R/A/W/T and PCN 19/R/A/W/T. CIV apron: PCN 21/R/B/W/T.
2	Taxiways	Width: 30 m EXC C-6, C-7: 23 m. Surface: Concrete. Strength: C-1, C-2, C-3, C-4, D-2, T-1, T-2, T-3, T-4 and T-5: PCN 28/R/B/W/T. C-5: PCN 34/R/A/W/T. C-6 and C-7: PCN 33/F/C/W/T.
3	Check locations	Altimeter: Military parking. ELEV 791 m/2594 ft. VOR: 208° / 3.7 NM FM THR 21. INS: Information not available. TACAN: 220° / 0.53 NM FM THR 21.
4	Remarks	None.

LESA AD 2.9 SURFACE MOVEMENT GUIDANCE AND CONTROL SYSTEM AND MARKINGS

1	Taxiing guidance system	Runway-holding positions, boards, NO ENTRY boards and stands.
---	-------------------------	---

2	RWY markings	Designators, threshold, centre line, side stripe and touchdown zone.
3	TWY markings	Centre line. EXC TWY C-6 and C-7: centre line and side stripe.
4	Remarks	None.

LESA AD 2.10 AERODROME OBSTACLES

In approach and take-off areas.

In circling area and at AD.

RWY Area	Obstruction	Coordinates	Obstruction	Coordinates
03	Cottages	030°/25 m FM THR ELEV:5 m HGT.	Arresting gear AERAZUR	16 m BFR THR 03 in APCH direction.
21	Hillock	210°/2 NM THR ELEV: 848 m.		

Observaciones: See AD 2-LESA AOC.

LESA AD 2.11 METEOROLOGICAL INFORMATION PROVIDED

1	MET office	CIV: Salamanca OMD. MIL: Matacán OMD.
2	HR	V: MON-FRI: 0500-1900; SAT & SUN: 0600-1900 / I: 0600-1800.
3	METAR	Half-hourly.
4	TAF	24 HR.
5	TREND	No.
6	Briefing	In person and by telephone.
7	Flight documentation/Language	Charts and plain language / Spanish.
8	Charts	Significant forecasted and wind and temperature aloft maps.
9	Supplementary equipment	Clouds, lightnings image and radar information image display.
10	ATS unit served	TWR, APP
11	Additional information	Madrid OMAe (LEMC): H-24 • TEL: +34-915 045 807 MET office Salamanca: H24 • TEL: +34-923 129 775
12	Remarks	Aerodrome climatological summary available. Aerodrome warnings available. Outside operational hours, the observer can be located at all times for situations of hours extension. 24 HR provision of Aerodrome Warning Bulletins for adverse phenomena. Other hours according to training periods.

LESA AD 2.12 RUNWAY PHYSICAL CHARACTERISTICS

RWY	TRUE BRG and MAG BRG	DIM (m)	THR PSN	THR ELEV / TDZ ELEV	SWY (m)	CWY (m)	Strip (m)	OFZ	RESA (m)	RWY/SWY SFC PCN
03	027.90°GEO 028°MAG	2513 x 45	405631.29N 0053032.53W	THR: 791 m/2595 ft /TDZ: No	275 x 45	No	2788 x 45	No	No	RWY: ASPH PCN 98/F/A/W/T SWY: Info no AVBL
21	207.91°GEO 208°MAG	2513 x 45	405743.29N 0052942.23W	THR: 788 m/2586 ft /TDZ: Info not AVBL	275 x 45	No	2788 x 45	No	No	RWY: ASPH PCN 98/F/A/W/T SWY: Info no AVBL

RWY	TRUE BRG and MAG BRG	DIM (m)	THR PSN	THR ELEV / TDZ ELEV	SWY (m)	CWY (m)	Strip (m)	OFZ	RESA (m)	RWY/SWY SFC PCN
07 (1)	074.10°GEO 074°MAG	1864 x 122	405659.89N 0053043.15W	THR: 788 m/2587 ft / TDZ: No	No	No	No	No	No	RWY: Hard soil 10000 kg SIWL 6.0 kg/cm ² SWY: No
25 (1)	254.11°GEO 254°MAG	1864 x 122	405716.44N 0052926.48W	THR: 789 m/2590 ft / TDZ: No	No	No	No	No	No	RWY: Hard soil 10000 kg SIWL 6.0 kg/cm ² SWY: No

Remarks: (1) Military use only.

12.1 PROFILE

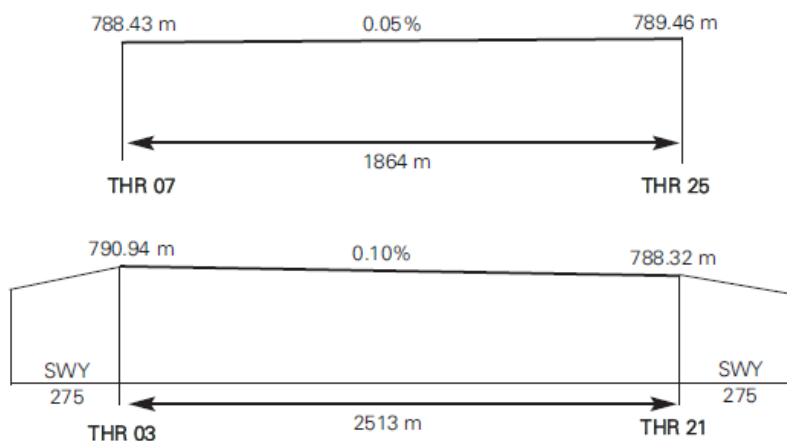

LESA AD 2.13 DECLARED DISTANCES

RWY	TORA (m)	TODA (m)	ASDA (m)	LDA (m)
03	2513	2513	2788	2513
21	2513	2513	2788	2513
07	1864	1864	1864	1864
25	1864	1864	1864	1864

Remarks: None.

LESA AD 2.14 APPROACH AND RUNWAY LIGHTING

1	Runway	03
2	Approach	Simple, 420 m. Threshold identification lights. LIM.
3	PAPI	3°.
4	Threshold	Green. LIH.
5	Touchdown zone	No.
6	Runway centre line	No.
7	Runway edge	2513 m: 1913 m white + 600 m yellow. LIH. Distance between lights: 60 m.

8	Runway end	Red. LIH.
9	Stopway	No.
10	Remarks	None.

1	Runway	21
2	Approach	Simple, 420 m. Threshold identification lights. LIM.
3	PAPI (MEHT)	3° (20 m / 66 ft).
4	Threshold	Green. LIH.
5	Touchdown zone	No.
6	Runway centre line	No.
7	Runway edge	2513 m: 1913 m white + 600 m yellow. LIH. Distance between lights: 60 m.
8	Runway end	Red. LIH.
9	Stopway	No.
10	Remarks	None.

1	Runway	07
2	Approach	No.
3	VASIS/PAPI	No.
4	Threshold	No.
5	Touchdown zone	No.
6	Runway centre line	No.
7	Runway edge	No.
8	Runway end	No.
9	Stopway	No.
10	Remarks	None.

1	Runway	25
2	Approach	No.
3	VASIS/PAPI	No.
4	Threshold	No.
5	Touchdown zone	No.

6	Runway centre line	No.
7	Runway edge	No.
8	Runway end	No.
9	Stopway	No.
10	Remarks	None.

LESA AD 2.15 OTHER LIGHTING, SECONDARY POWER SUPPLY

1	ABN	ALTN FLG W/G EV 6s. O/R. 405642N 0052937W.
2	WDI	1 near THR 03 NO LGTD, 1 near THR 21 LGTD.
3	TWY lighting	Edge.
4	Apron lighting	CIV: Yes, with floodlights. MIL: Yes, with floodlights.
5	Secondary power supply	There are two standby generators that provide a switch-over time (light) of 55 seconds approximately.
6	Remarks	None.

LESA AD 2.16 HELICOPTER LANDING AREA

1	Position	Near TWR.
2	Elevation	Information not available.
3	Dimensions, surface, maximum weight, marking	Circle 25 m. Grass.
4	Direction	Information not available.
5	Declared distances	Information not available.
6	Lighting	Information not available.
7	Remarks	NOT USEABLE.

LESA AD 2.17 AIR TRAFFIC SERVICES AIRSPACE

1	Designation	CTR SALAMANCA.
2	Lateral limits	Circle radius 7.5 NM centred on ARP. Extended 2.5 NM on the RWY 07 RCL direction, forming a 4 NM wide rectangle symmetric about the RCL extension.
3	Vertical limits	SFC – FL 100.
4	Airspace class	D.
5	Unit Language	Salamanca APP. ES/EN.
6	Transition altitude	1850 m / 6000 ft.

7	Hours of applicability	-
8	Remarks	None.

1	Designation	ATZ SALAMANCA.
2	Lateral limits	Circle radius 8 km centred on ARP. (1)
3	Vertical limits	SFC – 3000 ft HGT. (2)
4	Airspace class	D.
5	Unit Language	Salamanca TWR. ES/EN.
6	Transition altitude	-
7	Hours of applicability	-
8	Remarks	(1) Or the ground visibility, whichever is lower. (2) Or up to the cloud ceiling, whichever is lower.

LESA AD 2.18 AIR TRAFFIC SERVICES COMMUNICATION FACILITIES

Service	Call sign	FREQ	HR	Remarks
APP	Salamanca APP	124.405 C	HR MIL AD	APP/L
		121.500 MHz	HR MIL AD	EMERG
		257.800 MHz	HR MIL AD	MIL
		140.100 MHz	HR MIL AD	Local MIL
TWR	Salamanca TWR	118.105 C	HR MIL AD	-
		139.300 MHz	HR MIL AD	MIL
		243.000 MHz	HR MIL AD	EMERG
		121.855 C	HR MIL AD	GMC

LESA AD 2.19 RADIO NAVIGATION AND LANDING AIDS

Facility (VAR)	ID	FREQ	HR	Coordinates	DME ELEV	Remarks
VOR (0°W)	BBI	112.200 MHz	H24	410100.1N 0052724.6W	-	At 40 NM AVBL BTN: <ul style="list-style-type: none"> • R-120/R-140 at 7000 ft or ABV; • R-140/R-170 at 8000 ft or ABV; • R-170/R-240 at 7000 ft or ABV; • R-240/R-120 at 5000 ft or ABV.
DME	BBI	CH 59X	H24	410100.1N 0052724.9W	900 m	At 40 NM AVBL BTN: <ul style="list-style-type: none"> • R-120/R-140 at 7000 ft or ABV; • R-140/R-170 at 8000 ft or ABV; • R-170/R-240 at 7000 ft or ABV; • R-240/R-120 at 5000 ft or ABV.
LOC 21 ILS CAT (0°W)	IALR	110.100 MHz	H24	405623.3N 0053038.1W	-	208° MAG / 280 m FM THR 03. Caution due to possible false fly-up indications BTN 6 NM and 4 NM BLW GP.
GP 21	-	334.400 MHz	H24	405736.7N 0052953.1W	-	3°; RDH 16 m; at 300 m FM THR 21 & 124 m FM RCL to the right in APCH direction.

Facility (VAR)	ID	FREQ	HR	Coordinates	DME ELEV	Remarks
ILS/DME 21	IALR	CH 38X	H24	405736.7N 0052953.1W	795 m	REF DME THR 21.
TACAN (0°W)	TSC	CH 80X	H24	405718.8N 0053008.9W	810 m	Unmonitored facility.

LESA AD 2.20 LOCAL AERODROME REGULATIONS**20.1 CIVIL AIRCRAFT**

Civil aircraft not based at Salamanca AD:

- May be cleared to carry out practices of approaches, landing and take-off on Saturdays, Sundays and holidays prior request at least 72 hours in advance. Other days they will not be cleared.
- May experience delays due to schools flight activity, except for public passenger transport commercial flights.
- May operate outside operational hours, prior coordination, at least 60 minutes in advance, when performing domestic ambulance and/or organ transport flights.
- Operations outside HR CIV AD, except for public passenger transport commercial flights, must be requested from the operations office via e-mail to osalamanca@aena.es, at least 72 hours before the operation. The request must contain the following information:
 - Flight number and aircraft operator.
 - Flight type.
 - Type of aircraft and registration.
 - Date and time planned (arrival and/or departure).
 - Origin and/or destination.
 - Passenger manifest.
- Authorization for the operation will be issued by the same means by which it was requested.
- VFR flights may not be accomplished from Mondays to Fridays, other than public holidays, except for regular commercial flights.
- School flights will not be cleared from Mondays to Fridays (except public holidays).

20.2 CREW STAY IN CIVIL AIRCRAFT

Except in cases of force majeure, crew may stay in the aircraft up to one hour after landing, and may not accede to it until two hours before estimated time of departure.

20.3 FOREIGN STATE/MILITARY AIRCRAFT

PPR request is mandatory at least 72 hours in advance. When transporting dangerous goods or special operational needs this will be requested at least three working days in advance.

20.4 STATE SECURITY FORCES AIRCRAFT, MILITARY AND OTHER STATE AIRCRAFT

State Security Forces, Military and other state aircraft may operate outside operational hours, prior coordination, sending the request via FAX MIL at least 60 minutes in advance. In the request they must indicate: parent unit, number of aircraft, plans, schedule and POC.

20.5 PROCEDURE FOR THE REQUEST OF FIRE CATEGORY ON DEMAND

Salamanca Airport provides civil category 5 SEI continuously and 6 and 7 on demand. To operate with category 6 or 7 companies must request this from the operations office via e-mail to osalamanca@aena.es, at least 72 hours before the operation. The request must contain the following information:

- Flight number and aircraft operator.
- Flight type.
- Type of aircraft and registration.

- Date and time planned (arrival and/or departure).
- Origin and/or destination.
- Passengers manifest.

Confirmation of category 6 or 7 will be issued by the same means by which it was requested.

20.6 ENGINE TESTS

The engine tests for aircraft located on the civil apron, shall be carried out at the RWY 03 runway holding position or at RWY 21 runway holding position. The testing request shall be made to TWR, who shall determine at which of these points it must take place.

20.7 OPERATIONAL SAFETY REPORTS

Pilots/operator shall report to the airport as soon as possible about any accidents, incidents, occurrences or events which may have a potential operational impact and in which they have been involved or witnessed.

The aim of these reports is the compilation of the information in order to improve operational safety, independently of the compulsory report of the occurrence to the appropriate aeronautical authority. Data may be sent in any format, including at least the following information:

- Date and time.
- Site.
- Parties involved (data used to identify vehicles, aircraft...involved).
- Companies implicated.
- Description of the facts.
- Any other data considered relevant (e.g. lighting conditions, weather, phase of the operation such as take-off / landing / stopover, pavement conditions...).

Contact e-mail address of the airport, for the reception of operational safety reports, is the following: seguridad_operacional_slm@aena.es

In addition to notifying the airport by means of the indicated system, it is necessary to send at least basic data of the accident, incident, occurrence or event to the air traffic control service provider (ATC).

20.8 ARMS AND EXPLOSIVES INSPECTION SERVICE

For those passengers who are carrying arms and so that the control services necessary can be established, a request must be made at least 72 hours in advance, to osalamanca@aena.es

LESA AD 2.21 NOISE ABATEMENT PROCEDURES

No.

LESA AD 2.22 FLIGHT PROCEDURES

22.1 LOW VISIBILITY PROCEDURES (LVP)

Low Visibility Procedures (LVP) are not available at Salamanca airport.

22.2 AD TRAFFIC CIRCUIT

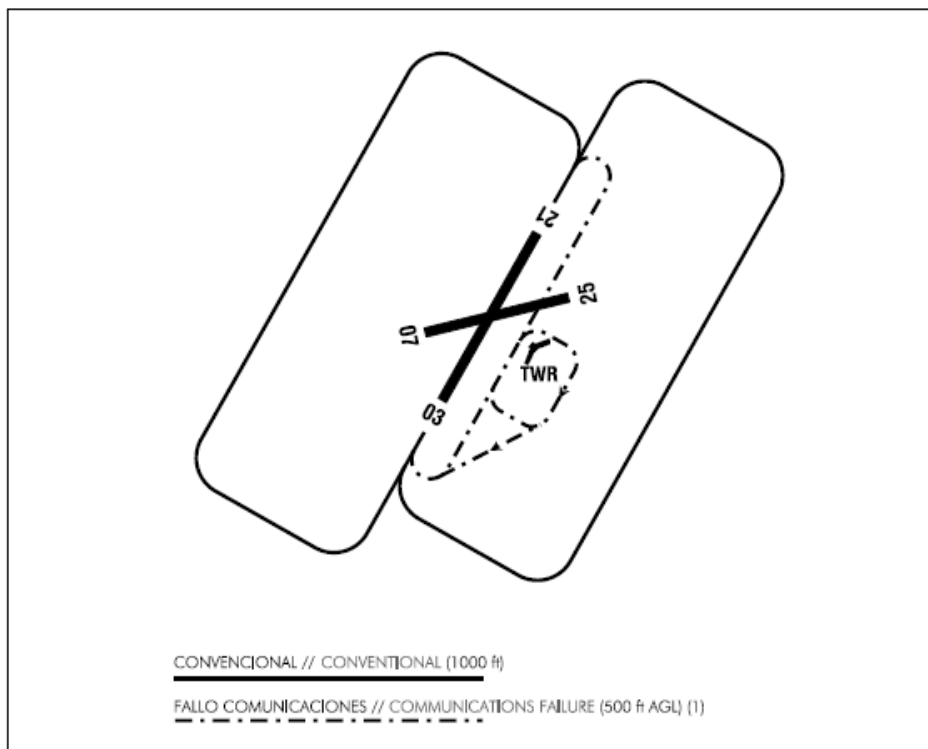

(1) Aircraft joining the communications failure circuit shall do so around the control tower, clockwise, maintaining appropriate safety distance from the runway and the main taxiway, and paying special attention to other aircraft which may be established in the visual circuits or making use of the runway.

LESA AD 2.23 ADDITIONAL INFORMATION**23.1 ARRESTING SYSTEMS**

Nomenclature: LESA-01-R-U.

Type: NET BARRIER UNIDIRECTIONAL.

Location on RWY: RWY 21 THR + 2430 m / 7972 ft.

Readiness status: Permanently available on pilot request.

23.2 BIRD CONCENTRATION AREAS AND BIRD MOVEMENT IN THE VICINITY OF THE AD

The following bird concentration and passage areas can be identified near the airport compound:

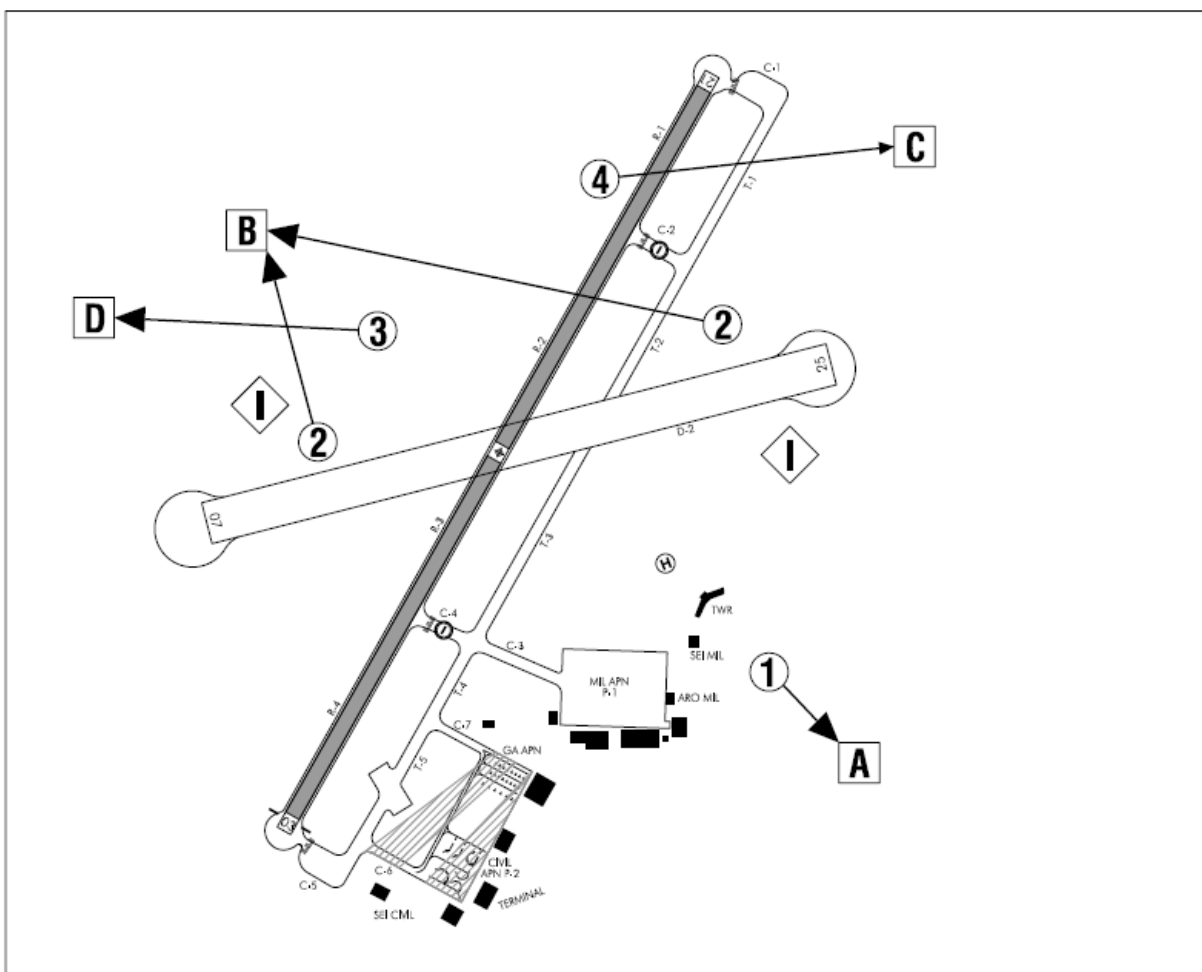

23.2.1 CONCENTRATION AREAS

Zone 1: concentration of pigeons.

Zone 2: concentration of starlings and lapwings (December-March).

Zone 3: concentration of crows.

Zone 4: concentration of common house martins (July-August).

23.2.2 FEEDING AREAS

Zone I: Crops areas.

23.2.3 BIRD MOVEMENT

Movement A: pigeons in flight.

Movement B: starlings and lapwings in flight.

Movement C: crows in flight.

Movement D: common house in flight.

23.3 POTENTIAL BIRD HAZARD AREAS

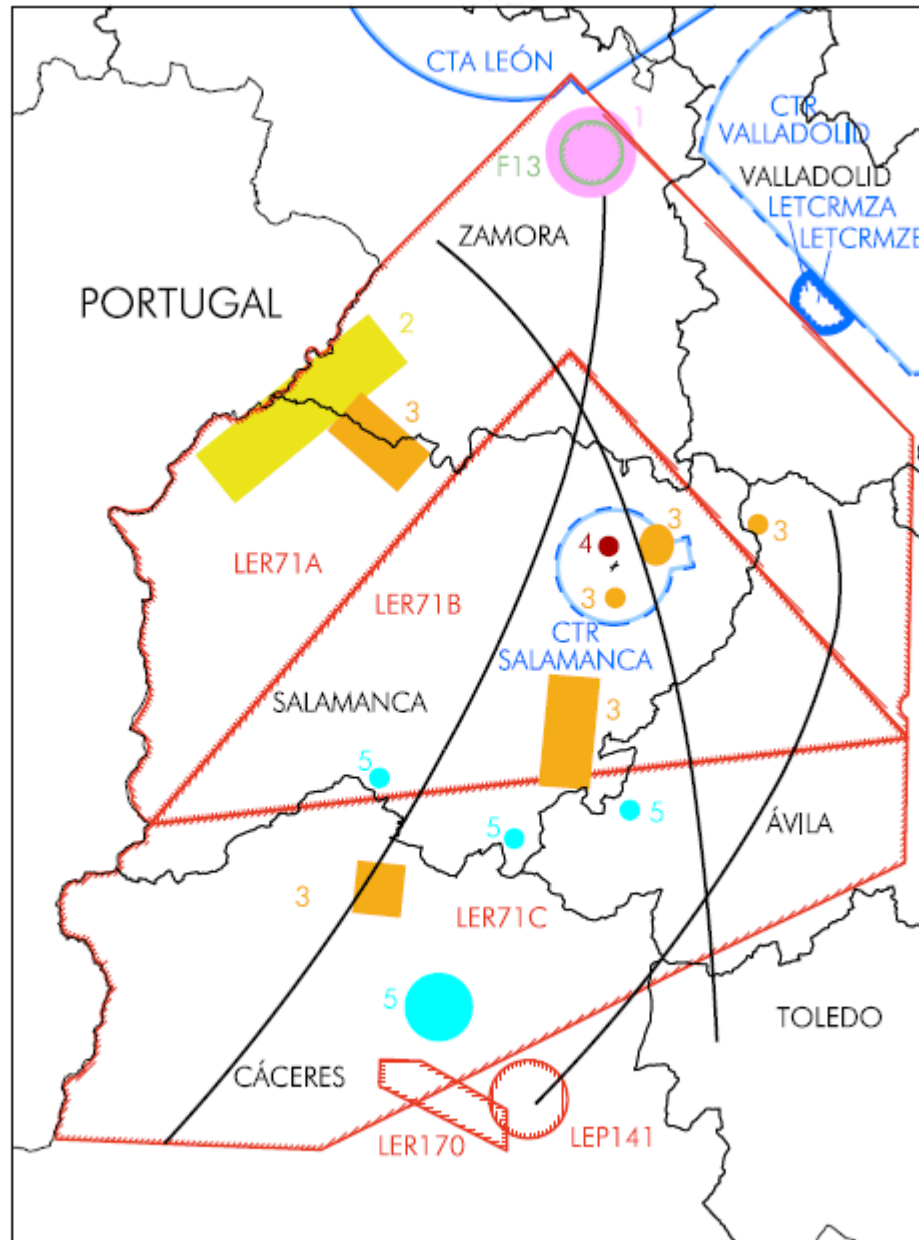

— Rutas migratorias, en invierno hacia el sur, en primavera/verano hacia el norte.
Migratory routes, to the south in Winter, to the north in Spring/Summer.

1. Natural reserve: SFC-1000 ft AGL.
 - o Bustard (+6 kg)
 - o Goose (4 kg)
 - o Medium-sized raptors (1.5 kg)
2. At sunrise and sunset below 1000 ft AGL; rest of the day above 1000 ft AGL.
 - o Black stork (+3 kg)
 - o Black griffon vulture (+10 kg)
3. They can fly at heights above 1000 ft although they are usually at low altitudes.
 - o Crane (+6 kg)
 - o Gray heron (+2 kg)
 - o Cormorant (+3 kg)
 - o Ash Gull (+1 kg)
 - o Bustard (+6 kg)
4. At mid and high altitudes all day.
 - o Stork (+3 kg)
 - o Griffon vulture (+8 kg)
 - o Black vulture (+10 kg)

- Seagull (+1 kg)
 - Red kite (+1.5 kg)
5. Heights above 1000 ft AGL.
- Black stork (+4 kg)
 - Griffon vulture (+8 kg)
 - Black vulture (+10 kg)
 - Red kite (+1.5 kg)

LESA AD 2.24 AERONAUTICAL CHARTS RELATED TO AN AERODROME

The list of charts related to the aerodrome can be found on the link below:

<https://aip.enaire.es/AIP/#LESA>

LESA AD 2.25 VISUAL SEGMENT SURFACE (VSS) PENETRATION

Not applicable.