

ESPAÑA

AIP-ESPAÑA

AIS-ESPAÑA

Dirección AFTN: LEANZXTA

Teléfono: +34 913 213 363

E-mail: ais@enaire.es

Web: www.enaire.es

ENAIRE

DIVISIÓN DE INFORMACIÓN AERONÁUTICA

c/ Campezo, 1. EDIFICIO 2

Kudos Innovation Campus Las Mercedes

28022 Madrid (ESPAÑA)

SUP 133/25

AIRAC 26-JUN-25

EFFECTIVE DATE WEF 07-AUG-25

AD

CANCEL: SUP 91/25

SUP 133/25

07AUG25/07AUG26EST

NOTE: EST SUP will only be cancelled by NOTAM, SUP or AIP amendment.

MADRID/Adolfo Suárez Madrid-Barajas AD (LEMD).- Resurfacing on TWY EA5 and Ramp 23.

Until 07 August 2026 (estimated), works will be under way in the airfield at Adolfo Suárez Madrid-Barajas Airport to resurface TWY EA5 and Ramp 23 (PRKG 500 to 537). Two new lit intermediate holding positions will also be established on TWY EA5 and TWY EA6.

The works have been divided into 8 phases. The order will be determined based on the airport's operational needs. The start and end dates of each phase, as well as any operational incidents which may arise, will be announced via NOTAM.

The works will be carried out continuously (H24).

The works will not be carried out whenever the LVP are in force.

The works will be duly marked and lit.

Caution is recommended due to the presence of personnel and machinery. Taxiing must be accomplished at minimum power in the vicinity of work zones in order to prevent the impact of jet efflux in areas where personnel are working.

Standard taxiing routes will be modified, and therefore ATC/SDP instructions must be followed for taxiing.

PHASE 1

Actions:

- Resurfacing on TWY EA5 in front of PRKG 500 to 502.
- Slab repair at PRKG 500 to 502.

Operational restrictions:

- Section of TWY EA5 between PRKG 500 and 502 closed.
- GATE 12 closed.
- PRKG 500 to 507 closed.
- PRKG 508: push-back nosing north, following the available tractor guidance signal.
- PRKG 510 to 526: push-back nosing north.

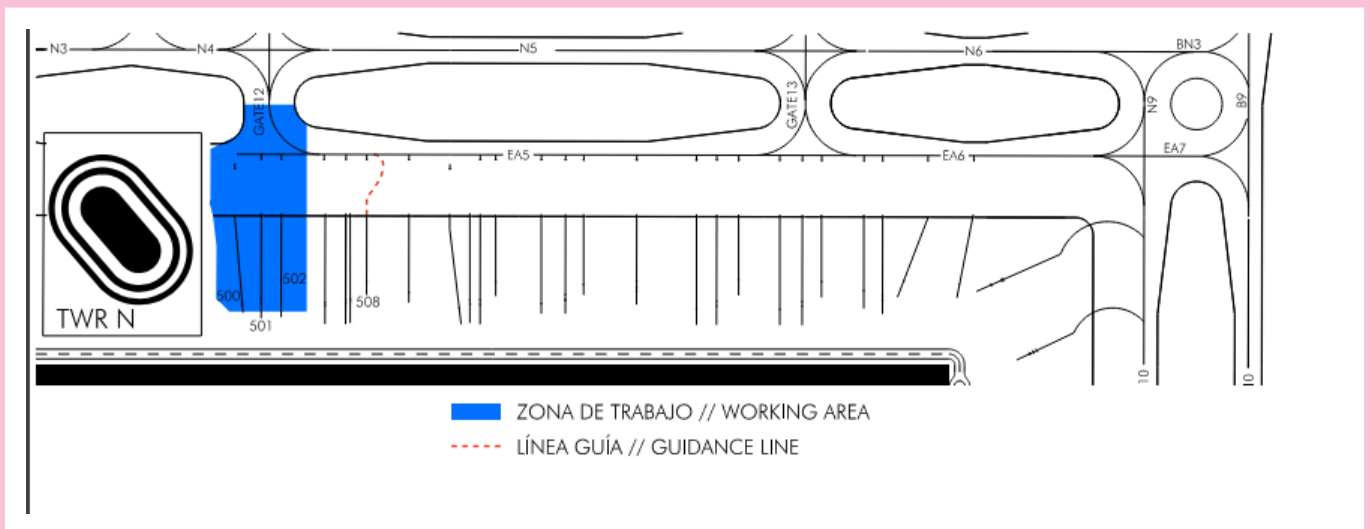

PHASE 2

Actions:

- Resurfacing on TWY EA5 in front of PRKG 504 to 512.
- Slab repair at PRKG 504 to 512.
- Installation of a new lit intermediate holding position on TWY EA5 in direction from TWY EA5 to GATE 12.

Operational restrictions:

- Section of TWY EA5 between PRKG 504 and 512 closed.
- GATE 12 closed.
- PRKG 500 to 516 closed.
- PRKG 518 and 519: push-back nosing north, following the available tractor guidance signal.
- PRKG 522 to 526: push-back nosing north.

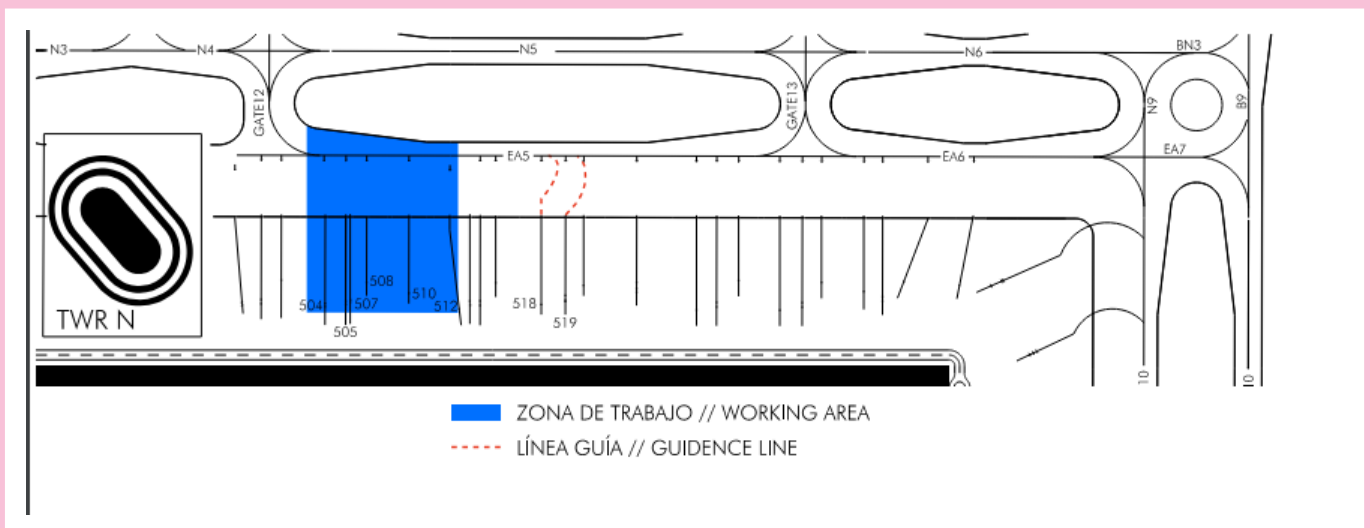

Final Configuration

- New lit intermediate holding position in a north-south direction on TWY EA5.

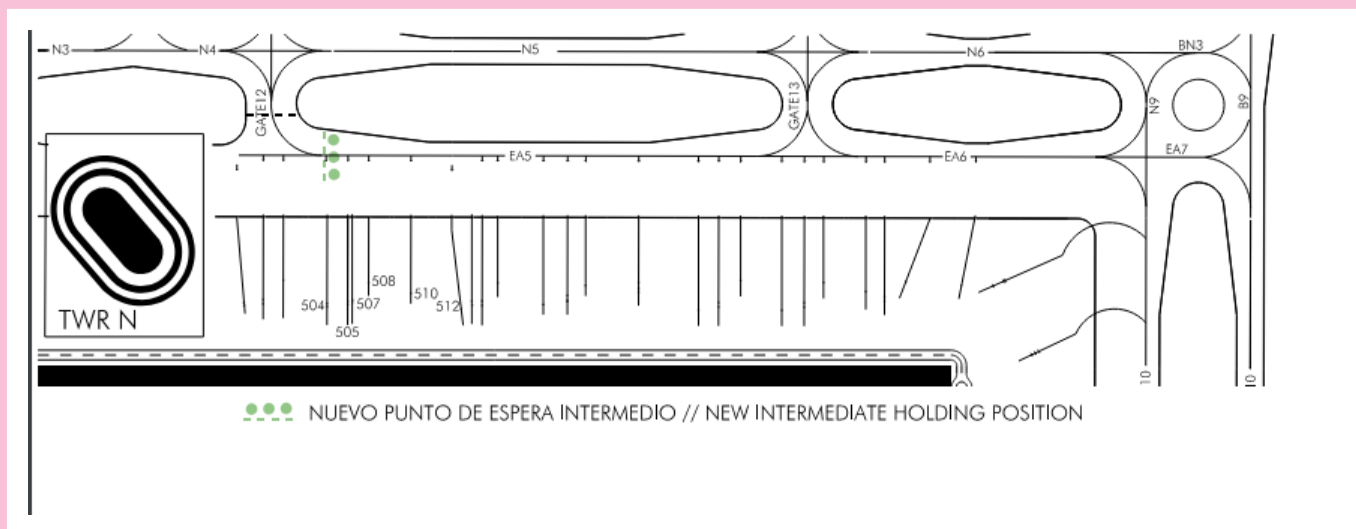

PHASE 3

Actions:

- Resurfacing on TWY EA5 between PRKG 512 and 520.
- Slab repair at PRKG 512 to 520.

Operational restrictions:

- Section of TWY EA5 between PRKG 512 and 520 closed.
- PRKG 510 to 522 closed.
- PRKG 524 to 526: push-back nosing north, following the available tractor guidance signal.
- PRKG 507 and 508: push-back nosing south, following the available tractor guidance signal.

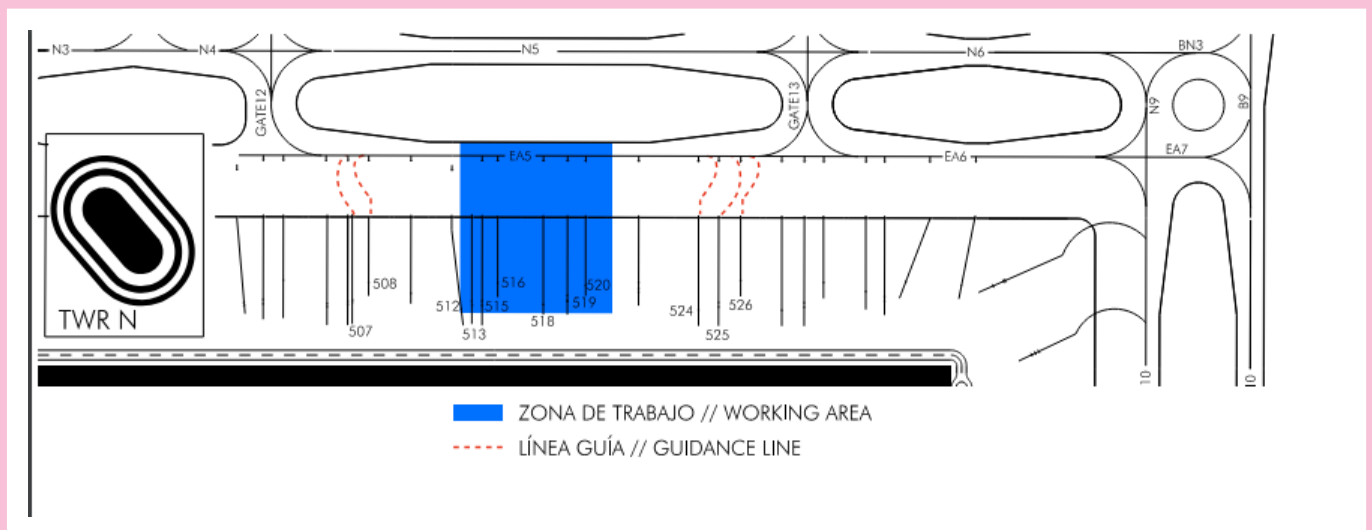

PHASE 4

Actions:

- Resurfacing on TWY EA5 in front of PRKG 522.
- Slab repair at PRKG 522.

Operational restrictions:

- Section of TWY EA5 in front of PRKG 522 closed.
- PRKG 519, 520, 522, 524 and 525 closed.
- PRKG 518: push-back nosing south, following the available tractor guidance signal.
- PRKG 526: push-back nosing north, following the available tractor guidance signal.

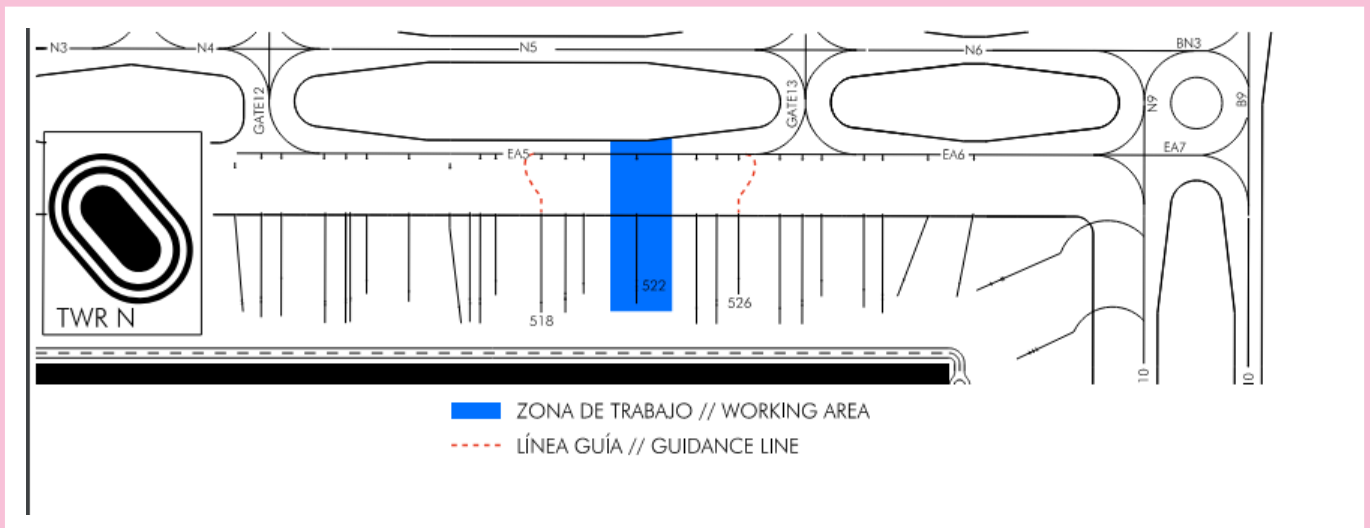

PHASE 5

Actions:

- Resurfacing on TWY EA5 in front of PRKG 524, 525, 526.
- Slab repair at PRKG 524, 525, 526.

Operational restrictions:

- Section of TWY EA5 between PRKG 524 and 526 closed.
- GATE 13 limited to maximum code letter C aircraft.
- PRKG 522, 524, 525, 526, 528 and 529 : closed.
- PRKG 519 and 520: push-back nosing south, following the available tractor guidance signal.
- PRKG 530 : push-back nosing south and exit via GATE 13.
- PRKG 532 to 533: push-back nosing north, following the available tractor guidance signal.
- PRKG 534-536 : push-back nosing north.

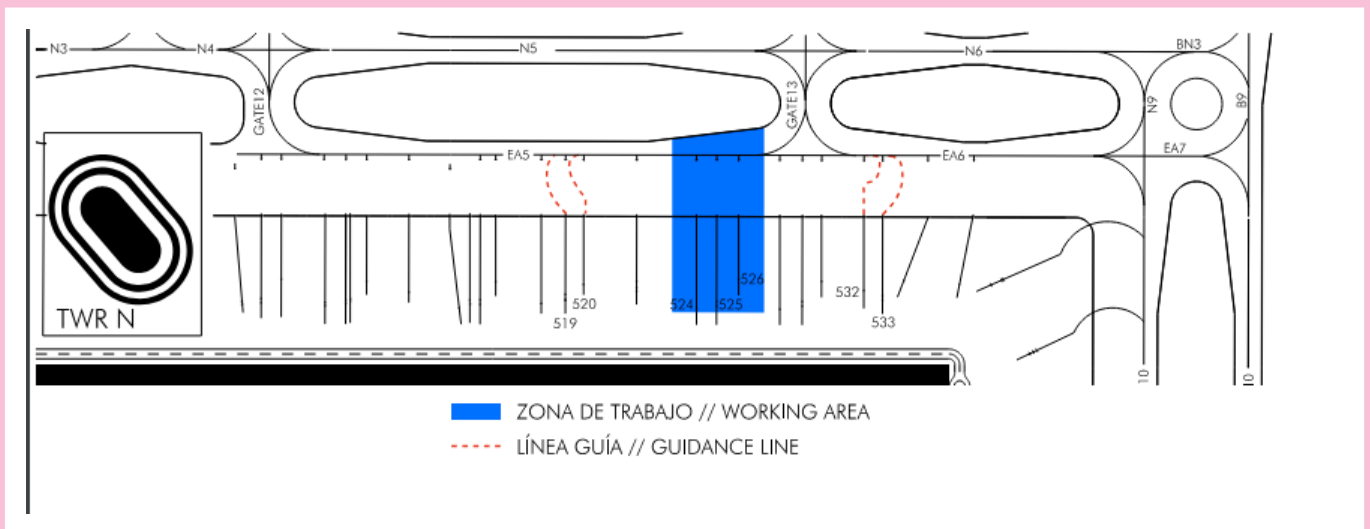

PHASE 6

Actions:

- Resurfacing on TWY EA5 in front of PRKG 528, 529, 530.
- Slab repair at PRKG 528, 529, 530.
- Installation of a new lit intermediate holding position on TWY EA6 in direction from TWY EA6 to EA5.

Operational restrictions:

- Section of TWY EA5 between PRKG 528 and 530 closed.
- GATE 13 closed.
- PRKG 525, 526, 528, 529, 530, 532, 533 closed.
- PRKG 524: push-back nosing south, following the available tractor guidance signal.
- PRKG 534: push-back nosing north, following the available tractor guidance signal.
- PRKG 536 push-back nosing north.

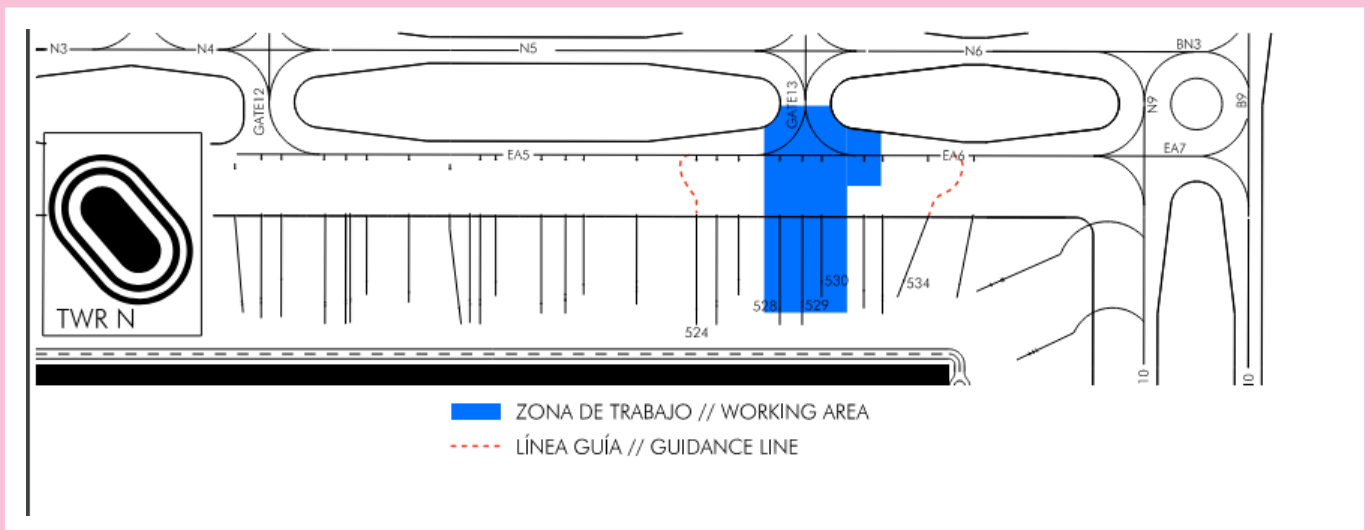

Final configuration

- New lit intermediate holding position in a north-south direction on TWY EA6.

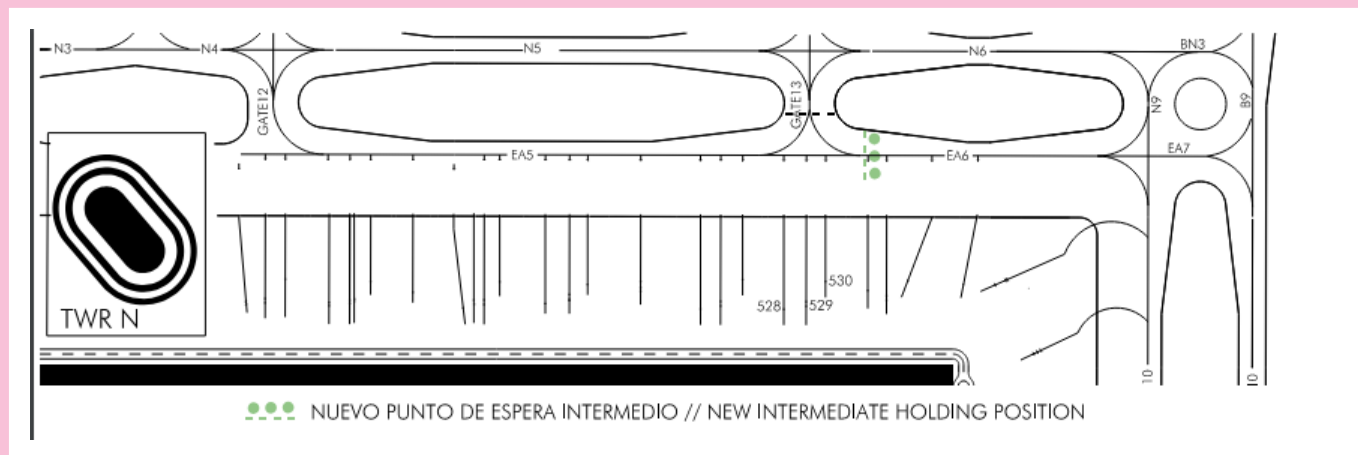

PHASE 7

Actions:

- Slab repair at PRKG 532, 533, 534.

Operational restrictions:

- PRKG 532, 533, 534 : closed.

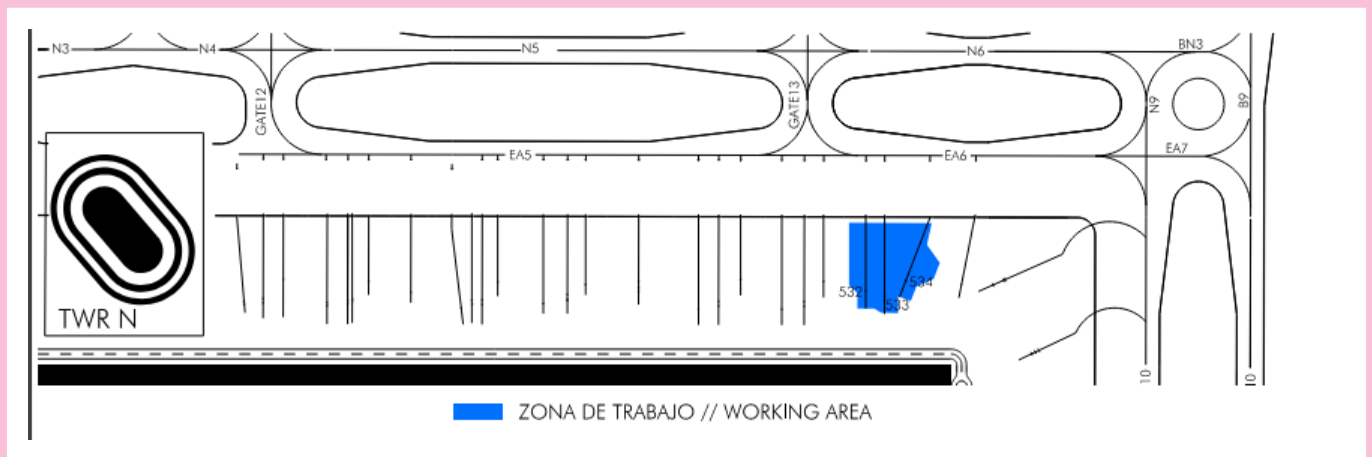

PHASE 8

Actions:

- Slab repair at PRKG 536 and 537.

Operational restrictions:

- PRKG 536 and 537 : closed.

